

Dušas kabīnes montāžas instrukcija

Инструкция по монтажу душевой кабины

Shower enclosure installation assembly

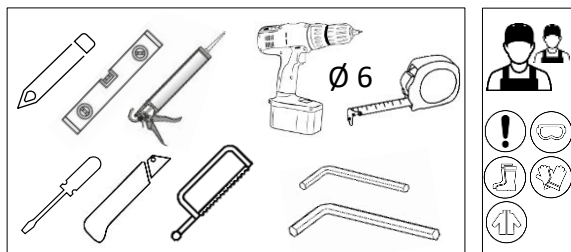

1.		PAL-01	1
2.		PAL-01B	1
3.		PAL-01B-AL	1
4.		SU45CH + SK2SET1	2
5.		VIRA20CH	1
6.		R1653308	1
7.		NLO-KP2908-6-2,5	1
8.		NLO-KP2908-8-2,5	1
9.		DR-CH32	1
10.		SC-10x15ST	1
11.		3,5x13 SK2SET	2
12.R		8536E6/EV5-135L	1
13.R		NFTA135R	1
12.L		NFTA135L	1
13.L		8536E6/EV5-135R	1
14.		3,5x35 SK1SET; Ø 6	2
15.		8 mm Safety Glass	1
16.		6 mm Safety Glass +VIRA20CH	1
17.		6 mm Safety Glass +VIRA20CH	1

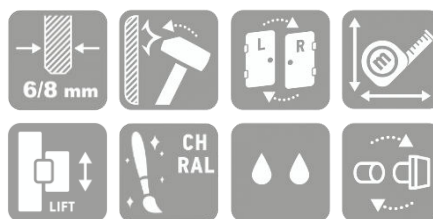
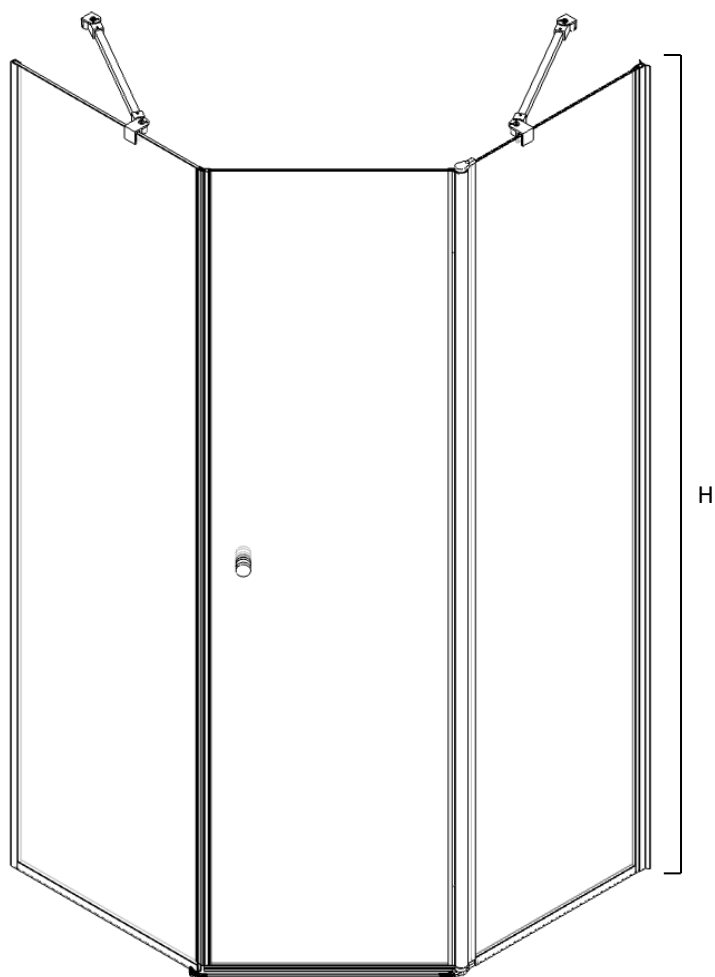

LEFT

RIGHT

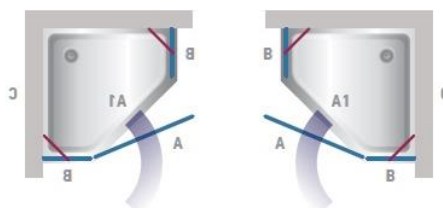

SIMONA	C (mm)	A (mm)	B (mm)	H (mm)
80X80SIM	790	490-495	425-430	1993
90X90SIM	890	490-495	525-530	1993
100X100SIM	990	590-595	555-560	1993
110X110SIM	1090	590-595	655-660	1993

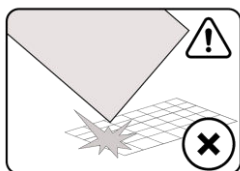
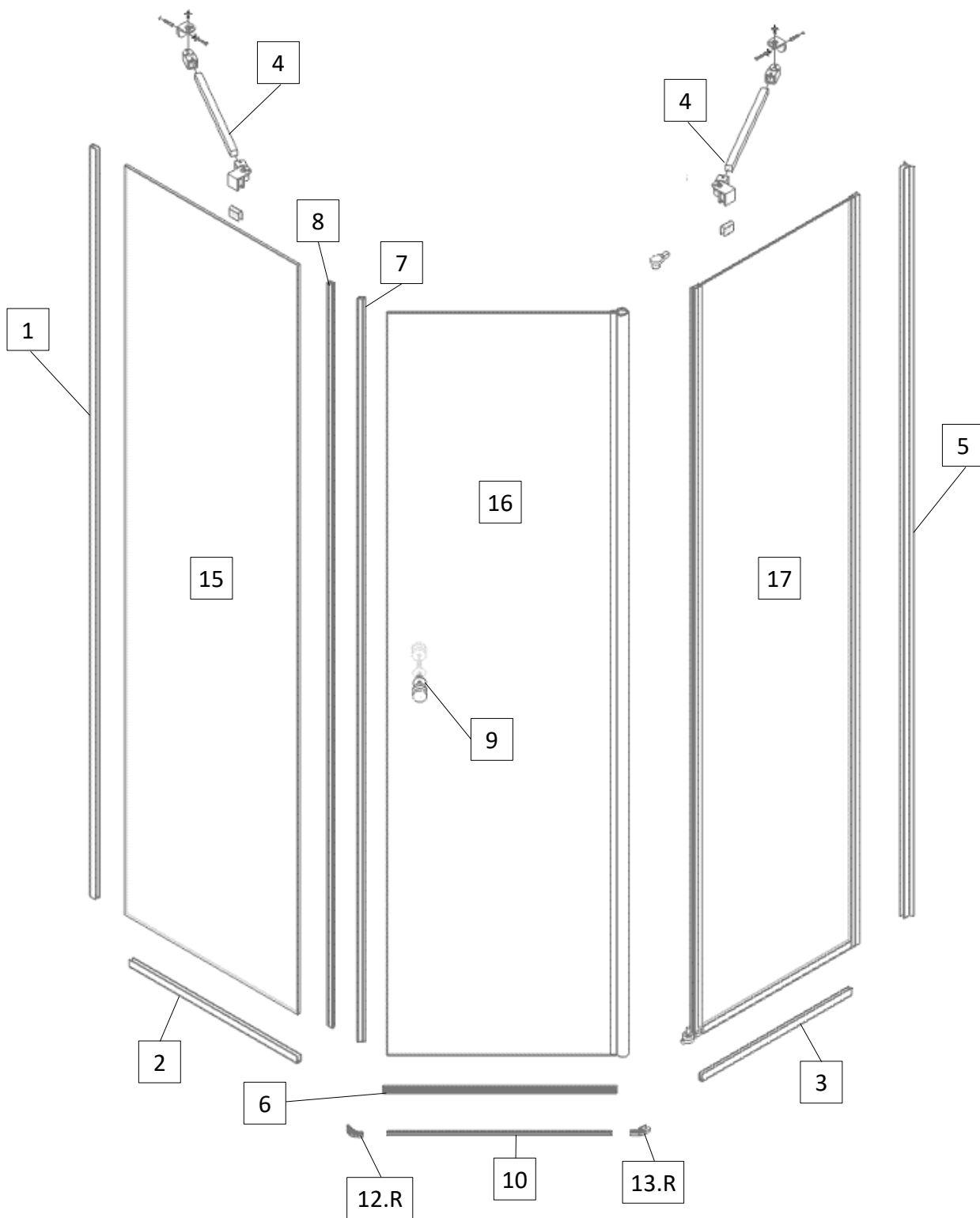

Uzmanību! Rūdīts stikls- rīkojieties uzmanīgi. Aizsargājiet stikla stūrus pret triecieniem.

Внимание! Закаленное стекло – будьте осторожны. Защищайте углы стекла от ударов.

Attention! Tempered glass - proceed with care. Protect the corners of the glass from impact.

1.A

SIMONA	P (mm)	C (mm)
80X80SIM	800 x 800	783
90X90SIM	900 x 900	883
100X100SIM	1000 x 1000	983
110X110SIM	1100 x 1100	1083

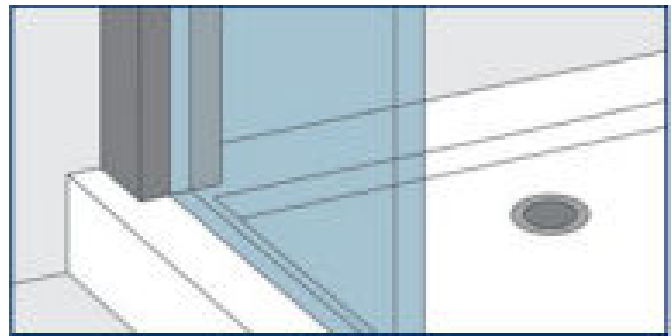
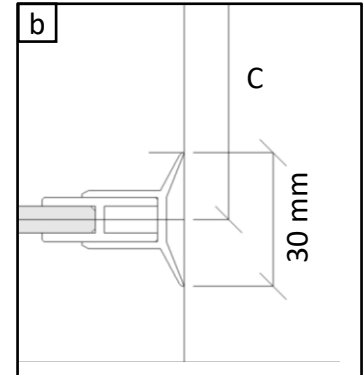
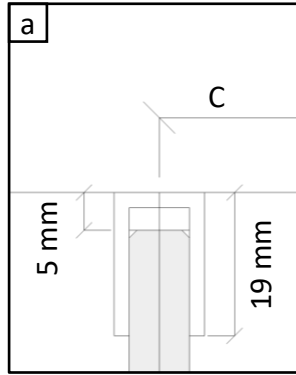
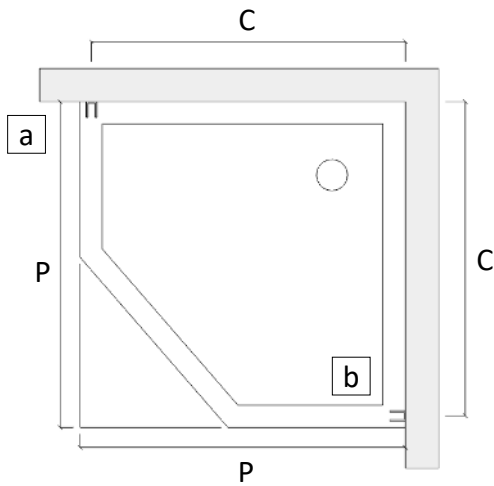

1.B

SIMONA	D (mm)	S (mm)
80X80SIM	800	800
90X90SIM	900	900
100X100SIM	1000	1000
110X110SIM	1100	1100

